

THIS DRAWING IS UNPUBLISHED. RELEASED FOR PUBLICATION
 © COPYRIGHT 19 BY AMP INCORPORATED. ALL INTERNATIONAL RIGHTS RESERVED.

REVISIONS									
LOC	DIST	P	F	ZONE	LTR	DESCRIPTION	DATE	APPD	
G	86				E	REV PER 063A-0659-00	09NOV00	3 ^R MS	

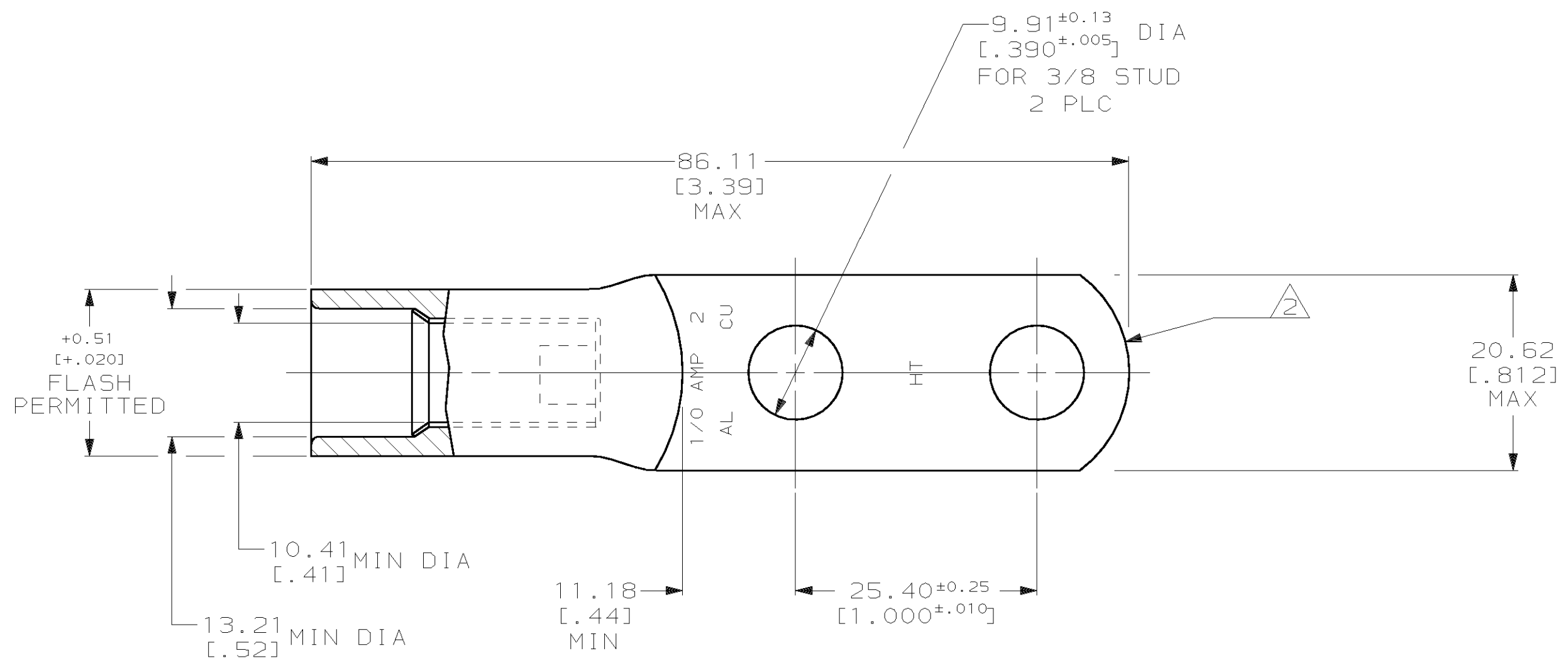

1 WIRE INSULATION: 10.79[.425] - 11.94[.470] DIA

△ THE TONGUE RADIUS FEATURE IS NOT A TOOLING CONTROLLED DIMENSION AND MAY NOT BE A TRUE RADIUS.

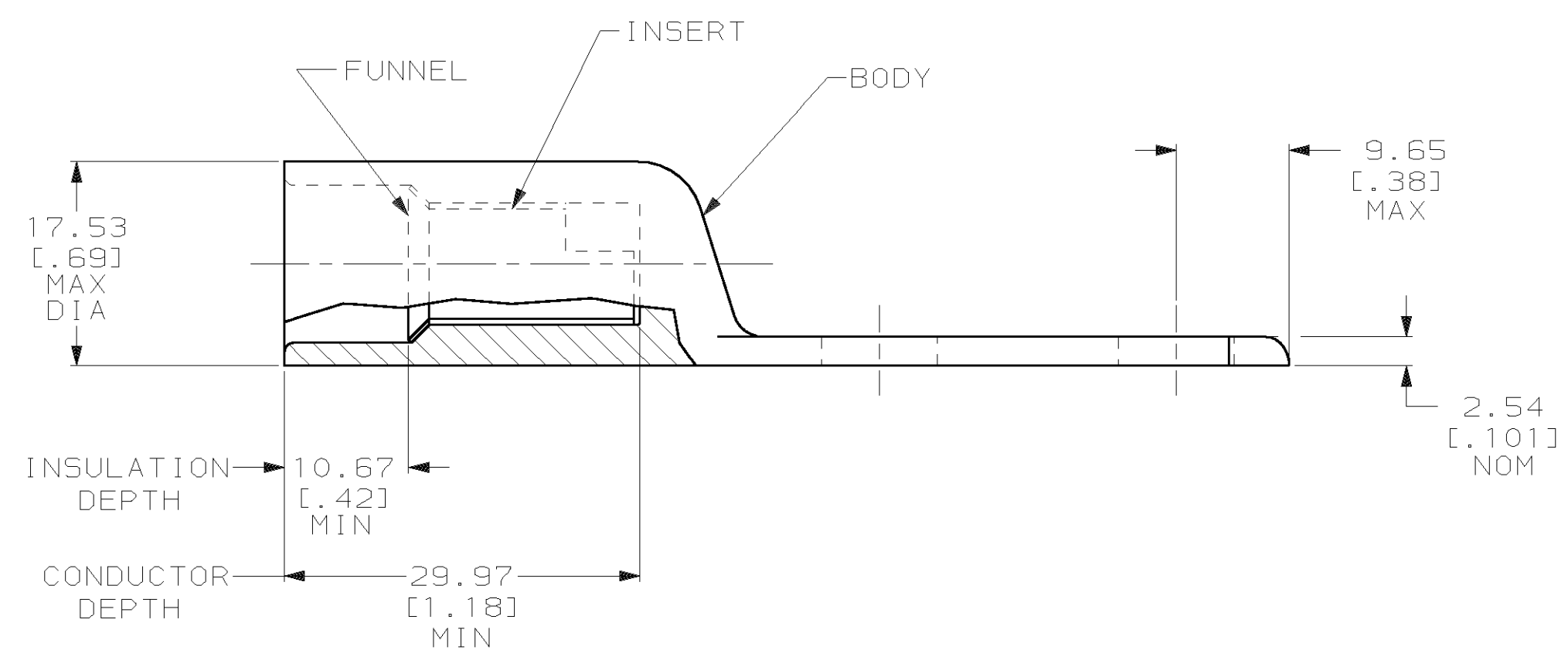

INSERT & FUNNEL: BRASS MIL-C-50 NICKEL PL QQ-N-290 0.00762[.000300] AVG THK	55838-1
BODY: COPPER ASTM B-187 ANNEALED SILVER PL QQ-S-365 0.00508[.000200] MIN THK	

DO NOT SCALE PRINT. UNLESS SPECIFIED DIMENSIONS IN mm [INCHES] TOLERANCES ON :		DR 6/15/92 DK SCHRUM		AMP Incorporated Harrisburg, PA 17105-3608	
2 PLC DEC ± - 3 PLC DEC ± - ANGLES ± -		CHK 6/16/92 WJ VOCKROTH			
MATERIAL		APPD 6/16/92 AJ KAUFMAN		NAME	
SEE TABLE		APPD 6/16/92 CR RH0ADS		WIRE TERMINAL, COPALUM™, SEALED, RING TONGUE, HIGH TEMP, WIRE SIZE: 51.50mm ² [1/0] ALUMINUM 34.55mm ² [2] COPPER	
FINISH		PRODUCT SPEC		SIZE	
SEE TABLE		108-11011 TENTATIVE		CAGE CODE	
		APPLICATION SPEC		DRAWING NO	
		114-2134		00779	
		WEIGHT		SCALE	
		62 GRAMS		2:1	
				SHEET	
				1 OF 1	

THIS DRAWING IS A CONTROLLED DOCUMENT FOR AMP INCORPORATED. IT IS SUBJECT TO CHANGE AND THE CONTROLLING ENGINEERING ORGANIZATION SHOULD BE CONTACTED FOR THE LATEST REVISION.